



## Farmland Sales Specialists

Setting the trend for how Real Estate is sold in the Midwest.  
[www.BarnesRealty.com](http://www.BarnesRealty.com)

18156 Hwy 59  
Mound City, MO 64470  
(660) 442-3177

1711 Oregon  
Hiawatha, KS 66434  
(785) 742-4580

1708 Prairie View Rd, Suite B  
Platte City, MO 64079  
(816) 219-3010

### *Riverfront Lots, Richardson County, NE*

Excellent Missouri River frontage! Enjoy Outdoor Recreation at its best! \$32,500 gets you Fee Simple title to your own River frontage. Lots vary in size. (Construction of roadway to each lot begins this month once surveyor marks the western property boundary)

#### **LOCATION:**

Just a bit less than 1 mile north of the town of Rulo and on the East side of the Road.

#### **PRICE:**

\$32,500.00/Lot

#### **IMPROVEMENT:**

Work is in progress for road improvement and access.

#### **UTILITIES:**

No electricity or water planned.

#### **FLOOD PLAIN:**

Any Living space built hereon is subject to certain FEMA rules and regulations- Short Version, you have to build any permanent living space above base flood elevation.

#### **LISTING AGENT:**

Jamie Barnes  
660-851-1125 or [jamie@barnesrealty.com](mailto:jamie@barnesrealty.com)

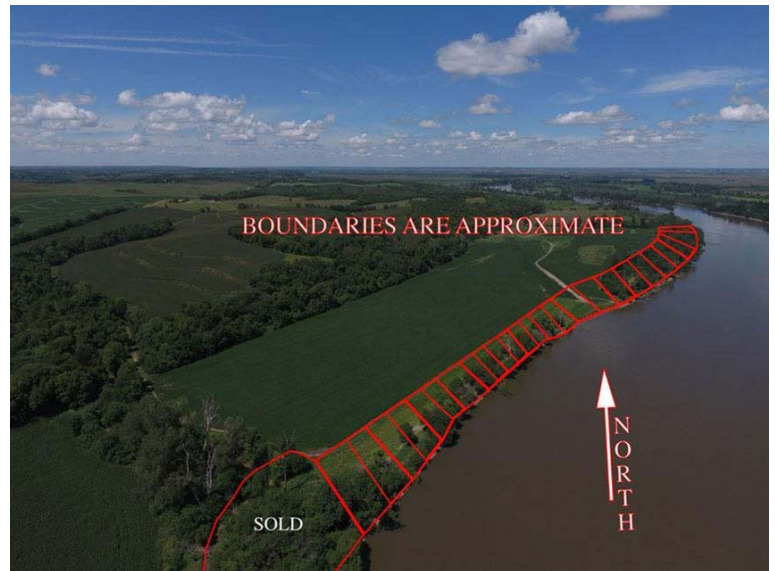

#### **BROKER PARTICIPATION:**

Barnes Realty Company, as listing broker, will gladly, and fully cooperate with most licensed real estate brokers to obtain a sale of the property on terms satisfactory to the current owners.

*Setting the trend for how Real Estate is sold in the Midwest.*

This information is thought to be accurate; however, it is subject to verification and no liability for error and omissions is assumed. Barnes Realty has made every effort to present accurate information on the property presented. Most of the information comes from outside sources: County/Government/Seller and human error can occur.

It's the Buyer's responsibility to satisfy him self with the information presented and to determine the information to be true and accurate and the property to be suited for his intended use. The listing may be withdrawn with or without approval. The Seller further reserves the right to reject any and all offers.

All inquiries, inspections, appointments, and offers must be sent through:

**RICK BARNES, BROKER, BARNES REALTY COMPANY, 18156 HWY 59, MOUND CITY, MO 64470 PHONE NUMBER: 1-660-442-3177.**

# ***Riverfront Lots, Richardson County, NE Driving Map***



## ***Google Aerial***



*Riverfront Lots, Richardson County, NE*  
*Aerial Photo*

